

Process Design & Automation Engineering for the world's leading **Industrial Manufacturers**

▶ **Matrix Technologies** has single-source capability for any process, facility, or automation engineering need.

With a professional team of engineering experts, in-depth process knowledge, and a proven project methodology, Matrix consistently delivers superior results on time and on budget.

Key Facts

- ▶ Established in **1980**
- ▶ **300+** employees
- ▶ Offices located in:
Atlanta
Cincinnati
Denver
Indianapolis
Kansas City
Maumee (Toledo)
Minneapolis
- ▶ Over **\$65 million** annual revenue
- ▶ Projects completed in **45 countries**
- ▶ **85%** of projects are repeat engagements with satisfied clients

Services

- Industrial Automation and Information Systems
- Manufacturing Intelligence/MES
- Process and Facility Engineering
- Engineer, Procure & Construct (EPC) Services for turnkey execution of large capital projects
- Power System Analysis & Design

Capabilities

- 3D Design
- 3D Laser Scanning
- Arc Flash Analysis
- Construction Services
- Consulting Services
- Control Systems
- Electrical Systems
- Facilities Design
- ICS Security
- Industrial Automation
- Industrial Engineering
- Industrial Networks
- Manufacturing Intelligence
- Process Design
- Project Management
- Regulatory Compliance
- Safety Services
- System Integration
- Virtual Infrastructure

Awards & Certifications



Market Sectors



Food & Beverage



Wine & Spirits



Pharmaceutical/
Biotech



Chemical



Oil & Gas



Consumer
Packaged Goods



Aggregates &
Mining



Metals

Maumee | Atlanta | Cincinnati | Denver | Indianapolis | Kansas City | Minneapolis

(419) 897-7200 | matrix@matrixti.com | matrixti.com



A Better Process for Success®

Representative **Projects**

▶ **Matrix Technologies** specializes in automation, engineering, manufacturing intelligence/MES, and EPC (Engineer, Procure & Construct) services. The company's expertise has been demonstrated in thousands of successful projects, including:

Oil, Gas & Chemical

- Retrofitted over 3,000 Fieldbus Foundation™ - powered instruments at a major oil refinery in a project to reduce downtime and ease maintenance.
- Designed new sulfur removal and amine recovery units for a Midwest oil refinery.
- Designed a \$45 million specialty chemical facility on a greenfield site in South Carolina.



Food & Beverage

- Designed and built a food production facility for a spice and flavoring manufacturing company.
- Designed a 10MM proof gallon / year greenfield spirits distillery for an industry-leading client.
- Retrofitted a 200,000-sq.ft. Kentucky warehouse for food product manufacturing in eight months.
- Designed and installed a 1,500 CPM food production process and packaging line.
- Provided design services to retrofit sauce processing and packaging lines to increase production flexibility.

▶ *Matrix develops industrial manufacturing projects from concept to completion for manufacturers in many diverse industries.*

Consumer Packaged Goods

- Upgraded aging control systems in multiple facilities across North America for a major charcoal manufacturer.
- Transformed a warehouse processing and packaging facility for a home cleaning products manufacturer.

Pharmaceutical

- Designed and implemented a batch control system for a biotech manufacturing facility.
- Designed and implemented a high-availability unified computing system with virtualized server environment.

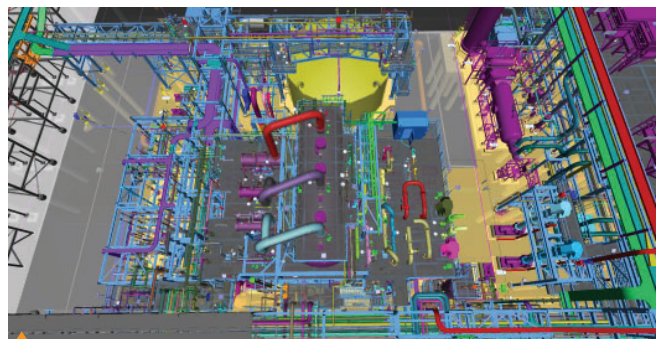
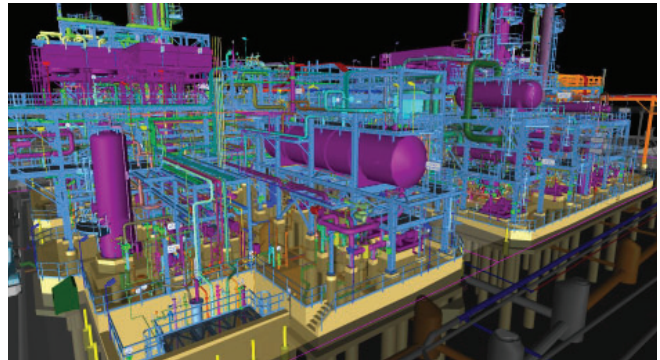

▶ *Matrix has advanced 3D design capabilities to create accurate models of facilities, processes, and equipment.*